

## Pattern/Flush Trim Bits with Insert Knives



### 657B

These bits complete the wide range of CMT Flush Trim bits equipped with a bearing. A larger 19mm diameter and double bearing distinguishes this bit from the others given its increased stability throughout flush and trimming operations. This means completing difficult projects safely, especially when you require a significant amount of swarf removal and an optimal precision finish.



#### CORRECT KNIFE POSITIONING

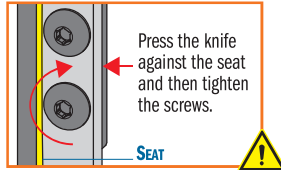

#### SAFETY TIPS



The **TW-006** Torque Screwdriver is recommended for the proper fastening of screws (see page 413).

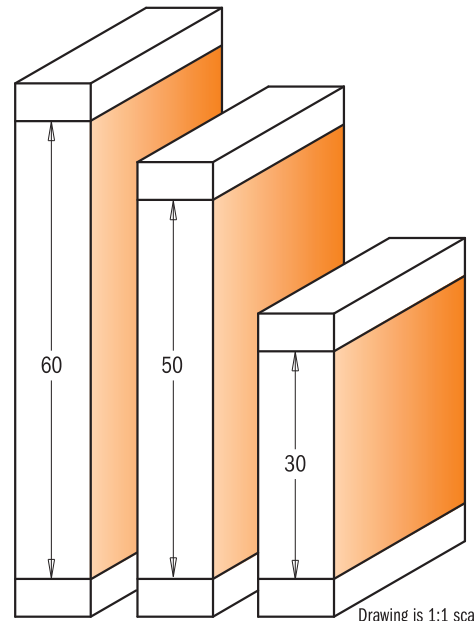

Drawing is 1:1 scale

I mm	D mm	L mm		ORDER NO. S=Ø8mm	ORDER NO. S=Ø12mm	ORDER NO. S=Ø12,7mm
30	19	90	10	<b>657.191.11B</b>		<b>657.692.11B</b>
30	19	90	10			
50	19	110	10		<b>657.993.11B</b>	<b>657.994.11B</b>
60	19	120	10		<b>657.995.11B</b>	<b>657.996.11B</b>

#### Spare parts

790.300.00	990.075.00	791.007.00	990.052.00	791.034.00	541.004.00
790.300.00	990.075.00	791.007.00	990.052.00	791.011.00	541.002.00
790.500.00	990.075.00	791.007.00	990.052.00	791.011.00	541.002.00
790.600.00	990.075.00	791.007.00	990.052.00	791.011.00	541.002.00

Spare parts: **990.410.00** Ø4,2/Ø9mm shield for M4 screws  
**991.067.00** 3mm hex key

**991.061.00** T15 TORX® key  
**991.056.00** 1,5mm hex key

## Flush Trim Router Bits with Double Bearing

### 806/906B

The innovative two-flute router bits are equipped with a double bearing and feature a down shear design allowing cleaner, smoother cuts on a variety of materials.

Now it's no longer necessary to flip or move your tool during routing operations. This tool is particularly effective when routing curved elements along or against the grain.

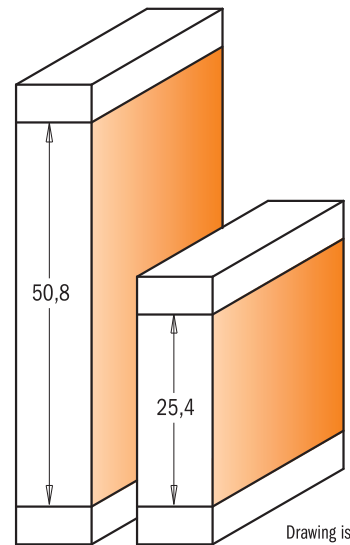

Drawing is 1:1 scale



I mm	D mm	L mm	α		ORDER NO. S=Ø12mm	ORDER NO. S=Ø12,7mm
25,4	19	86,5	-5°	10	<b>906.691.11B</b>	
25,4	19	86,5	-5°	10		<b>806.691.11B</b>
50,8	19	109,5	-3°	10	<b>906.690.11B</b>	
50,8	19	109,5	-3°	10		<b>806.690.11B</b>

#### Spare parts

990.425.00	791.004.00	541.550.00	990.058.00	791.011.00	541.005.00
990.425.00	791.004.00	541.550.00	990.058.00	791.011.00	541.002.00
990.425.00	791.004.00	541.550.00	990.058.00	791.011.00	541.005.00
990.425.00	791.004.00	541.550.00	990.058.00	791.011.00	541.002.00

Spare parts: **991.057.00** 3/32" hex key